



# CHECK VALVES



**GUARANTEED**  
Reliability With  
Economy

# DESIGN & TESTING

- BSS Check Valves are designed to prevent loss of media caused by failed connections and for uni-directional flow control of fluids in chemical processing, power generation, oil and gas industries.
- Every Valve is factory tested for cracking and reseal performance
- All Check Valves have a standard working pressure of 6000psi
- Heat Code Traceability
- Variety of End connections includes NPT, BSPP, BSPT, Metric and Tube Ends
- Maximum working pressure of 10000psi is available upon request
- Every Valve is tested for both, crack and reseal
- Choice of cracking pressure from 1/3 to 25psig

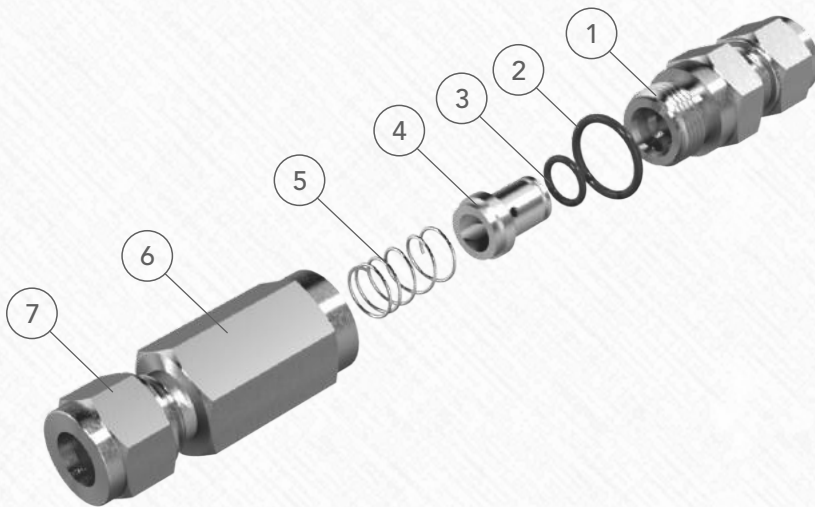

Component	Materials Grade / ASTM Specification
1. Body (Outlet)	A276 or A479 / SS316
2. Seal (O-Ring)	Viton / FKM / Buna-N
3. End Seal (O-Ring)	
4. Poppet	A276 or A479 / SS316
5. Spring	
6. Body (inlet)	
7. Nut, Ferrule	

# PRESSURE AND TEMPERATURE RATINGS

Material	Pressure Rating	
316SS	1/8" to 3/4"	6000 psig C W P (413 bar)
	1"	3000 psig C W P (207 bar)
Brass	1/8" to 1"	3000 psig C W P (207 bar)

**NOTE:** Valves may initially crack at higher pressure if not actuated for a period of time.

# CHECK VALVES



## MALE X FEMALE

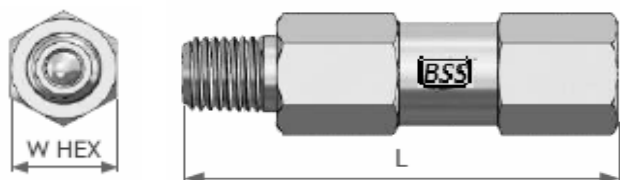

Part Number	End Connection		Dimensions (MM)	
	Inlet	Outlet	L	W Hex
BSS-CV-FF-4N	1/4" NPT		73	19
BSS-CV-FF-6N	3/8" NPT		73	22
BSS-CV-FF-8N	1/2" NPT		80	27
BSS-CV-FF-12N	3/4" NPT		105	35
BSS-CV-FF-16N	1" NPT		110	41

## FEMALE X FEMALE

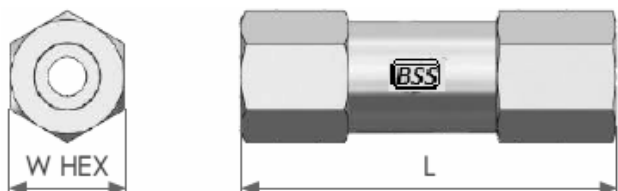

Part Number	End Connection		Dimensions (MM)	
	Inlet	Outlet	L	W Hex
BSS-CV-FF-4N	1/4" NPT		70	19
BSS-CV-FF-6N	3/8" NPT		71	22
BSS-CV-FF-8N	1/2" NPT		75	27
BSS-CV-FF-12N	3/4" NPT		95	35
BSS-CV-FF-16N	1" NPT		105	41

## TUBE ENDS



Part Number	End Connection		Dimensions (MM)	
	Inlet	Outlet	L	W Hex
BSS-CV-TE-6MT	6 MM ODT		80	19
BSS-CV-TE-4T	1/4" ODT		80	19
BSS-CV-TE-8T	8 MM ODT		85	19
BSS-CV-TE-6T	3/8" ODT		85	19
BSS-CV-TE-10MT	10 MM ODT		85	19
BSS-CV-TE-12MT	12 MM ODT		100	19
BSS-CV-TE-8T	1/2" ODT		100	19
BSS-CV-TE-12T	3/4" ODT		112.5	32
BSS-CV-TE-16T	1" ODT		134	41