



INSTRUMENTATION PIPE FITTINGS



GUARANTEED
Reliability With
Economy



FEATURES

- Precision Pipe Fittings for Instrumentation and Process Control
- Size ranges from 1/16" to 2"
- All fittings have a high-quality appearance
- Straight fittings are manufactured from Bar stock and Shaped fittings are manufactured from forgings
- For smooth flow path, elbows are designed with radius junction
- Every fitting is marked with Manufacturer's name, Size, Material and Heat Code for traceability
- All threads are capped and properly packed to ensure they are not damaged during transit
- Pressure ratings are based on ASME Process Piping Code B31.3 at ambient temperature
- Construction equals or exceeds requirements of ASME B1.20.1 to ensure maximum thread engagement

PRESSURE RATING

| NPT/ISO Pipe Size | Stainless steel 316 | | | | Brass | | | | Carbon Steel | | | |
|----------------------|---------------------|--------|--------|-------|-------|-------|--------|-------|--------------|--------|--------|-------|
| | Male | | Female | | Male | | Female | | Male | | Female | |
| | Bar | Psig | Bar | Psig | Bar | Psig | Bar | Psig | Bar | Psig | Bar | Psig |
| 1/8 | 689 | 10,000 | 420 | 6,100 | 337 | 4,900 | 207 | 3,000 | 689 | 10,000 | 420 | 6,100 |
| 1/4 | 558 | 8,100 | 434 | 6,300 | 275 | 4,000 | 214 | 3,200 | 558 | 8,100 | 434 | 6,300 |
| 3/8 | 524 | 7,600 | 345 | 5,000 | 262 | 3,800 | 172 | 2,500 | 524 | 7,600 | 345 | 5,000 |
| 1/2 | 517 | 7,500 | 324 | 4,700 | 255 | 3,700 | 158 | 2,300 | 517 | 7,500 | 324 | 4,700 |
| 3/4 | 496 | 7,200 | 303 | 4,400 | 248 | 3,600 | 152 | 2,200 | 496 | 7,200 | 303 | 4,400 |
| 1 | 365 | 5,300 | 296 | 4,300 | 172 | 2,500 | 145 | 2,100 | 365 | 5,300 | 296 | 4,300 |

- Pressure ratings are calculated at -28 to 37°C (-20 to 100°F) using allowable stress value of 20,000psi for SS 316, 10,000psi for Brass and 20,000psi for Carbon Steel as per ASME B31.3 Process Piping Code
- Pressure ratings are listed for temperatures up to 37°C (100°F)
- To determine the pressure ratings in accordance with ASME B31.1, Power Piping:
 - Carbon Steel material – multiply by 0.85
 - Stainless Steel and Brass material – remains the same

MATERIAL STANDARDS

| Material | Bar Stock | Forging |
|--------------|----------------------------------|----------------------------------|
| 316 SS | ASTM A276, ASME SA479, EN 1.4401 | ASTM A182, ASME SA182, EN 1.4401 |
| Alloy 400 | ASTM B164, ASME SB164 | ASTM B564, ASME SB564 |
| Alloy 600 | ASTM B166, ASME SB166 | ASTM B564, ASME SB564 |
| Brass | ASME B16/ASTM B453 | ASTM B283 |
| Carbon Steel | ASTM A108 | ASTM A105 |

THREAD SPECIFICATIONS

| THREAD TYPE | SPECIFICATION |
|----------------------|-----------------------------------|
| NPT | ASME B1.20.1, SAE AS71051 |
| ISO Tapered Threads | ISO 7-1, BS EN 10226-1, JIS B0203 |
| ISO Parallel Threads | ISO 228, JIS B0202 |
| Unified (SAE) | ASME B1.1/ SAE J475 |
| Metric | ISO 261 |

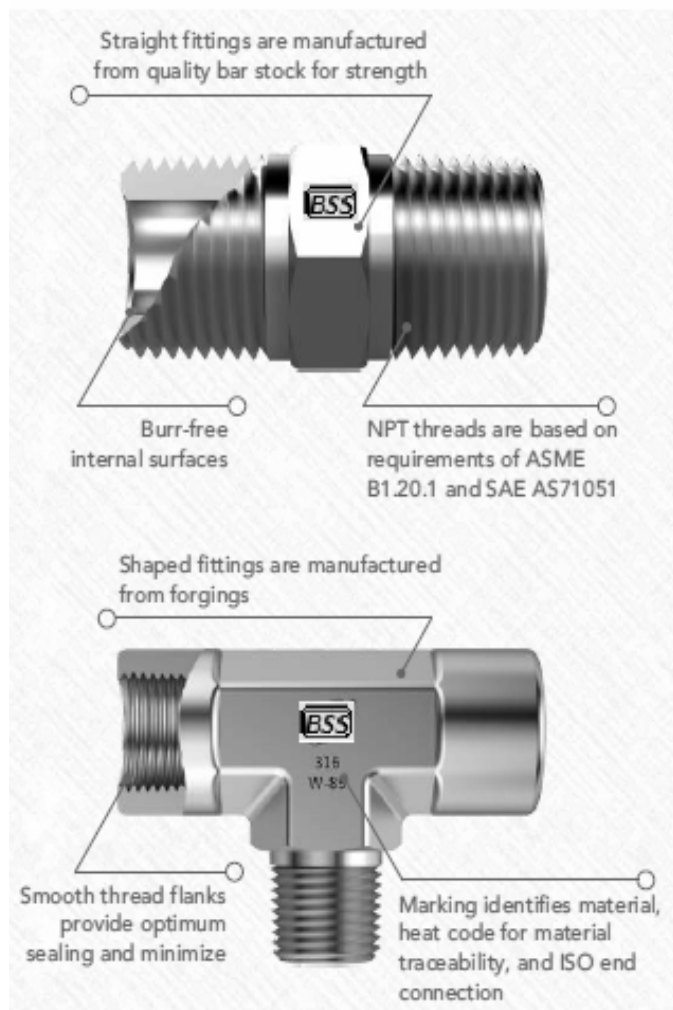

INSTALLATION INSTRUCTIONS

To ensure a leak-tight seal, BSS recommends the use of a pipe thread sealant on all NPT threads. The most effective sealing method is PTFE tape. Tape should be used only on male tapered pipe threads. Do not use tape on flared, coned or tube fitting ends! Clean both male and female tapered threads. Wrap tape in the direction of the male tapered thread spiral.

NOTE: Two wraps are suggested for stainless steel tapered pipe threads. Make sure tape does not overhang the first thread, as the tape might shred and enter the fluid system. Cut off excess tape. The connection is now ready for proper makeup.

CLEANING

BSS pipe fittings are free from machine oils, loose particles and grease throughout the close cleaning process.

ORDERING INFORMATION PIPE FITTINGS



BSS - HRN - 8N-4N - SS6 - 10K

MANUFACTURER

(BSS)

FITTING TYPES

| | | | |
|-----|-----------------------|-----|-----------------------|
| CN | Close Nipple | ME | Male Elbow |
| HN | Hex Nipple | SE | Street Elbow |
| HRN | Hex Reducing Nipple | RSE | Reducing Street Elbow |
| HLN | Hex Long Nipple | FT | Female Tee |
| A | Adapter | MT | Male Tee |
| GA | Gauge Adapter | BT | Branch Tee |
| RA | Reducing Adapter | ST | Street Tee |
| RB | Reducing Bushing | C | Cross |
| HC | Hex Coupling | CP | Pipe Cap |
| HRC | Hex Reducing Coupling | HP | Hex Plug |
| FE | Female Elbow | P | Pipe Plug |

CONNECTION SIZE

| Size | Use Code |
|--------|----------|
| 1/16" | 1 |
| 1/8" | 2 |
| 1/4" | 4 |
| 3/8" | 6 |
| 1/2" | 8 |
| 3/4" | 12 |
| 1" | 16 |
| 1-1/4" | 20 |
| 1-1/2" | 24 |
| 2" | 32 |

CONNECTION TYPE

| TYPE | Use Code |
|--------|----------|
| NPT | N |
| BSPP | G |
| BSPT | GT |
| METRIC | M |
| SOCKET | SW |

MATERIAL

| | | | |
|--------|--------------|----------|-----------------|
| (SS6) | SS316 | (M) | Monel 400 |
| (SS6L) | SS316L | (HC-276) | Hastelloy C-276 |
| (SS4) | SS304 | (IC625) | Inconel 625 |
| (D) | Duplex | (IC825) | Inconel 825 |
| (SD) | Super Duplex | (CS) | Carbon Steel |

SPECIAL REQUIREMENTS (MULTIPLE OPTIONS AVAILABLE)

| | |
|-------|-----------------------------|
| (N) | NACE Compliance |
| (10K) | 10,000 Psi Working Pressure |

HEX NIPPLES

MALE NPT

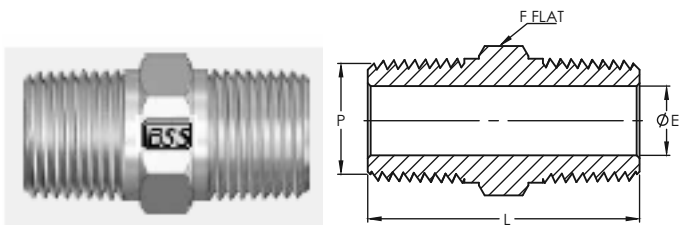

| Part Number | Pipe Size (in) P NPT | Dimensions (mm) | | |
|-------------|-------------------------|-----------------|------|--------|
| | | L | Ø E | F Flat |
| BSS-HN-1N | 1/16 | 25.6 | 3.0 | 7.94 |
| BSS-HN-2N | 1/8 | 25.6 | 4.8 | 11.11 |
| BSS-HN-4N | 1/4 | 35.6 | 7.1 | 14.29 |
| BSS-HN-6N | 3/8 | 36.3 | 9.6 | 17.46 |
| BSS-HN-8N | 1/2 | 46.7 | 11.9 | 22.22 |
| BSS-HN-12N | 3/4 | 46.7 | 15.7 | 27.00 |
| BSS-HN-16N | 1 | 58.9 | 22.4 | 34.92 |

MALE ISO TAPERED THREAD

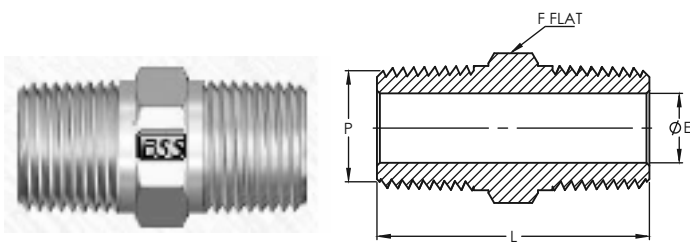

| Part Number | Thread (in) P ISO | Dimensions (mm) | | |
|-------------|----------------------|-----------------|------|--------|
| | | L | Ø E | F Flat |
| BSS-HN-2GT | 1/8 | 25.6 | 4.8 | 11.11 |
| BSS-HN-4GT | 1/4 | 35.6 | 7.1 | 14.29 |
| BSS-HN-6GT | 3/8 | 36.3 | 9.6 | 17.46 |
| BSS-HN-8GT | 1/2 | 46.7 | 11.9 | 22.22 |

MALE NPT TO MALE ISO TAPERED THREAD

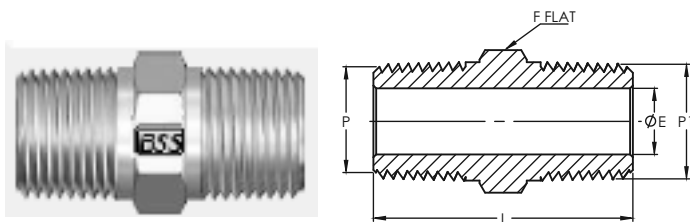

| Part Number | P NPT (in) | P1 ISO Thread (in) | Dimensions (mm) | | |
|-----------------|---------------|-----------------------|-----------------|------|--------|
| | | | L | Ø E | F Flat |
| BSS-HN-2N-2GT | 1/8 | 1/8 | 25.6 | 4.8 | 11.11 |
| BSS-HN-4N-4GT | 1/4 | 1/4 | 35.6 | 7.1 | 14.29 |
| BSS-HN-6N-6GT | 3/8 | 3/8 | 36.3 | 9.6 | 17.46 |
| BSS-HN-8N-8GT | 1/2 | 1/2 | 46.7 | 11.9 | 22.22 |
| BSS-HN-12N-12GT | 3/4 | 3/4 | 46.7 | 15.7 | 27.00 |
| BSS-HN-16N-16GT | 1 | 1 | 58.9 | 22.4 | 34.92 |

MALE NPT TO MALE ISO PARALLEL THREAD

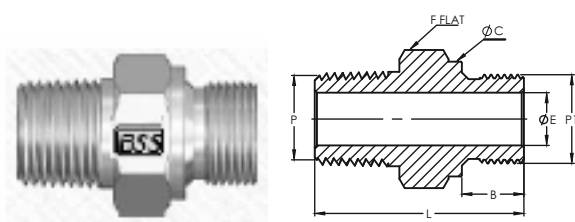

| Part Number | P NPT (in) | P1 ISO Thread (in) | L | B | Dimensions (mm) | | |
|----------------|---------------|-----------------------|------|------|-----------------|------|--------|
| | | | | | Ø C | Ø E | F Flat |
| BSS-HN-2N-2G | 1/8 | 1/8 | 27.7 | 8.1 | 13.7 | 4.1 | 14.29 |
| BSS-HN-4N-4G | 1/4 | 1/4 | 36.8 | 11.9 | 17.8 | 5.8 | 19.05 |
| BSS-HN-6N-6G | 3/8 | 3/8 | 37.6 | 11.9 | 21.8 | 7.9 | 22.22 |
| BSS-HN-8N-8G | 1/2 | 1/2 | 44.4 | 14.0 | 25.9 | 11.9 | 27.00 |
| BSS-HN-12N-12G | 3/4 | 3/4 | 49.0 | 16.0 | 31.8 | 15.7 | 33.92 |
| BSS-HN-16N-16G | 1 | 1 | 56.6 | 18.0 | 38.9 | 19.8 | 41.27 |

The E dimension is the minimum nominal opening. These fittings may have a larger opening at one end.

HEX REDUCING NIPPLES

MALE NPT

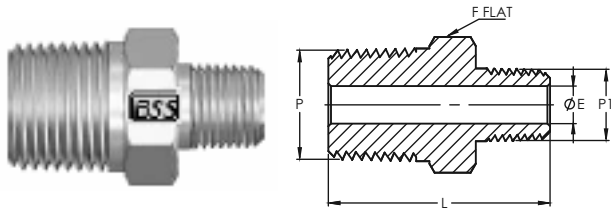

| Part Number | Pipe Size (in) | | Dimensions (mm) | | |
|-----------------|----------------|--------|-----------------|------|--------|
| | P NPT | P1 NPT | L | Ø E | F Flat |
| BSS-HRN-2N-1N | 1/8 | 1/16 | 25.6 | 3.0 | 11.11 |
| BSS-HRN-4N-2N | 1/4 | 1/8 | 31.0 | 4.8 | 14.29 |
| BSS-HRN-6N-2N | 3/8 | 1/8 | 31.8 | 4.8 | 17.46 |
| BSS-HRN-6N-4N | 3/8 | 1/4 | 36.3 | 7.1 | 17.46 |
| BSS-HRN-8N-2N | 1/2 | 1/8 | 37.3 | 4.8 | 22.22 |
| BSS-HRN-8N-4N | 1/2 | 1/4 | 41.9 | 7.1 | 22.22 |
| BSS-HRN-8N-6N | 1/2 | 3/8 | 41.9 | 9.6 | 22.22 |
| BSS-HRN-12N-4N | 3/4 | 1/4 | 41.9 | 7.1 | 27.00 |
| BSS-HRN-12N-8N | 3/4 | 1/2 | 46.7 | 11.9 | 27.00 |
| BSS-HRN-16N-4N | 1 | 1/4 | 49.3 | 7.1 | 34.92 |
| BSS-HRN-16N-8N | 1 | 1/2 | 54.1 | 11.9 | 34.92 |
| BSS-HRN-16N-12N | 1 | 3/4 | 54.1 | 15.7 | 34.92 |

The E dimension is the minimum nominal opening. These fittings may have a larger opening at one end.

MALE ISO TAPERED THREAD

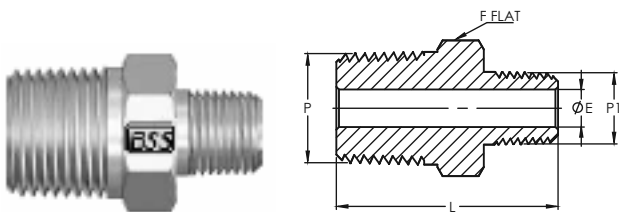

| Part Number | Thread Size (in) | | Dimensions (mm) | | |
|-----------------|------------------|--------|-----------------|-----|--------|
| | P ISO | P1 ISO | L | Ø E | F Flat |
| BSS-HRN-6GT-4GT | 3/8 | 1/4 | 36.3 | 7.1 | 17.46 |
| BSS-HRN-8GT-2GT | 1/2 | 1/8 | 37.3 | 4.8 | 22.22 |
| BSS-HRN-8GT-6GT | 1/2 | 3/8 | 41.9 | 9.6 | 22.22 |

The E dimension is the minimum nominal opening. These fittings may have a larger opening at one end.

HEX LONG NIPPLES

MALE NPT

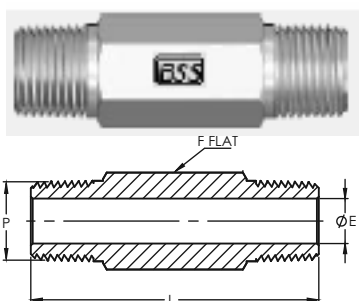

| Part Number | Pipe Size (in) P NPT | LG (Available Length) | Dimensions (mm) | |
|------------------|-------------------------|----------------------------|-----------------|--------|
| | | | Ø E | F Flat |
| BSS-HLN-2N-(LG) | 1/8 | 1.5" / 2" / 2.5" / 3" | 4.8 | 11.11 |
| BSS-HLN-4N-(LG) | 1/4 | 1.5" / 2" / 2.5" / 3" / 4" | 7.1 | 14.29 |
| BSS-HLN-6N-(LG) | 3/8 | 1.5" / 2" / 2.5" / 3" / 4" | 9.6 | 17.46 |
| BSS-HLN-8N-(LG) | 1/2 | 2" / 3" / 4" / 6" | 11.9 | 22.22 |
| BSS-HLN-12N-(LG) | 3/4 | 2" / 3" / 4" | 15.7 | 27.00 |
| BSS-HLN-16N-(LG) | 1 | 3" / 4" | 22.4 | 34.92 |

LG- Length to be Order (Required)

CLOSE NIPPLES MALE NPT

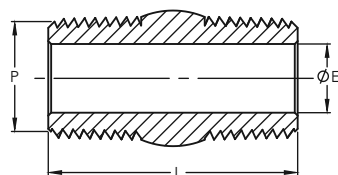

| Part Number | Pipe Size (in) P NPT | Dimensions (mm) | |
|-------------|-------------------------|-----------------|------|
| | | L | Ø E |
| BSS-CN-2N | 1/8 | 19.1 | 4.8 |
| BSS-CN-4N | 1/4 | 28.4 | 7.1 |
| BSS-CN-6N | 3/8 | 28.4 | 9.6 |
| BSS-CN-8N | 1/2 | 38.1 | 11.9 |
| BSS-CN-12N | 3/4 | 38.1 | 15.7 |
| BSS-CN-16N | 1 | 47.8 | 22.4 |

HEX COUPLINGS FEMALE NPT

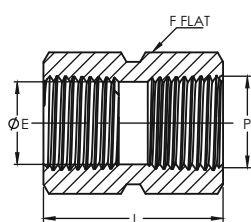

| Part Number | Pipe Size (in) P NPT | L | Dimensions (mm) | |
|-------------|-------------------------|------|-----------------|--------|
| | | | Ø E | F Flat |
| BSS-HC-2N | 1/8 | 20.6 | 8.4 | 14.29 |
| BSS-HC-4N | 1/4 | 30.2 | 11.4 | 19.05 |
| BSS-HC-6N | 3/8 | 33.3 | 15.0 | 22.22 |
| BSS-HC-8N | 1/2 | 39.6 | 18.5 | 27.00 |
| BSS-HC-12N | 3/4 | 41.1 | 23.9 | 34.92 |
| BSS-HC-16N | 1 | 50.8 | 29.7 | 41.27 |

FEMALE ISO TAPERED THREAD

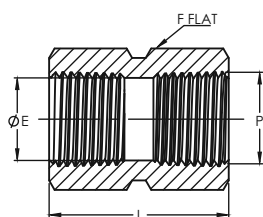

| Part Number | Thread Size (in) P ISO | L | Dimensions (mm) | |
|-------------|---------------------------|------|-----------------|--------|
| | | | Ø E | F Flat |
| BSS-HC-2GT | 1/8 | 20.6 | 8.4 | 14.29 |
| BSS-HC-4GT | 1/4 | 30.2 | 11.2 | 19.05 |
| BSS-HC-6GT | 3/8 | 33.3 | 14.7 | 22.22 |
| BSS-HC-8GT | 1/2 | 39.6 | 18.3 | 27.00 |

HEX REDUCING COUPLINGS

FEMALE NPT

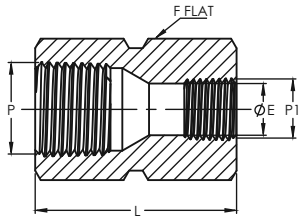

| Part Number | Pipe Size (in) | | Dimensions (mm) | | |
|-----------------|----------------|--------|-----------------|------|--------|
| | P NPT | P1 NPT | L | Ø E | F Flat |
| BSS-HRC-4N-2N | 1/4 | 1/8 | 31.0 | 8.6 | 19.05 |
| BSS-HRC-6N-4N | 3/8 | 1/4 | 35.1 | 11.4 | 22.22 |
| BSS-HRC-8N-2N | 1/2 | 1/8 | 39.6 | 8.6 | 27.00 |
| BSS-HRC-8N-4N | 1/2 | 1/4 | 44.4 | 11.4 | 27.00 |
| BSS-HRC-8N-6N | 1/2 | 3/8 | 45.2 | 15.0 | 27.00 |
| BSS-HRC-12N-4N | 3/4 | 1/4 | 46.0 | 11.4 | 34.92 |
| BSS-HRC-12N-8N | 3/4 | 1/2 | 52.3 | 18.5 | 34.92 |
| BSS-HRC-16N-8N | 1 | 1/2 | 55.6 | 18.5 | 41.27 |
| BSS-HRC-16N-12N | 1 | 3/4 | 57.2 | 23.9 | 41.27 |

FEMALE ISO TAPERED THREAD

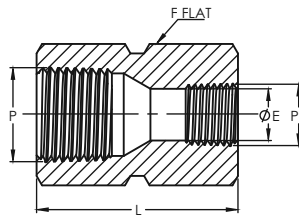

| Part Number | Thread Size (in) | | Dimensions (mm) | | |
|-----------------|------------------|--------|-----------------|------|--------|
| | P ISO | P1 ISO | L | Ø E | F Flat |
| BSS-HRC-6GT-4GT | 3/8 | 1/4 | 35.1 | 11.2 | 22.22 |
| BSS-HRC-8GT-4GT | 1/2 | 1/4 | 44.4 | 11.2 | 27.00 |
| BSS-HRC-8GT-6GT | 1/2 | 3/8 | 45.2 | 14.7 | 27.00 |

ADAPTERS

FEMALE TO MALE NPT

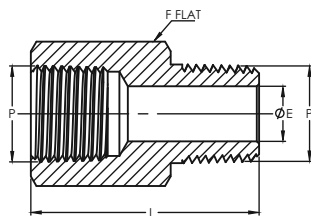

| Part Number | Pipe Size (in) | Dimensions (mm) | | |
|-------------|----------------|-----------------|------|--------|
| | P NPT | L | Ø E | F Flat |
| BSS-A-2N | 1/8 | 27.9 | 4.8 | 14.29 |
| BSS-A-4N | 1/4 | 35.6 | 7.1 | 19.05 |
| BSS-A-6N | 3/8 | 38.4 | 9.6 | 22.22 |
| BSS-A-8N | 1/2 | 49.3 | 11.9 | 27.00 |
| BSS-A-12N | 3/4 | 51.3 | 15.7 | 34.92 |
| BSS-A-16N | 1 | 57.9 | 22.4 | 41.27 |

FEMALE TO MALE ISO TAPERED THREAD

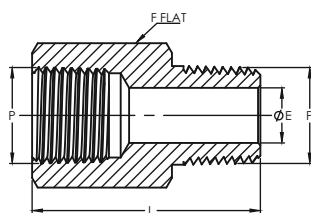

| Part Number | Thread Size (in) | Dimensions (mm) | | |
|-------------|------------------|-----------------|------|--------|
| | P ISO | L | Ø E | F Flat |
| BSS-A-2GT | 1/8 | 27.7 | 4.8 | 14.29 |
| BSS-A-4GT | 1/4 | 36.1 | 7.1 | 19.05 |
| BSS-A-6GT | 3/8 | 38.1 | 9.6 | 22.22 |
| BSS-A-8GT | 1/2 | 49.5 | 11.9 | 27.00 |

FEMALE NPT TO MALE ISO TAPERED THREAD

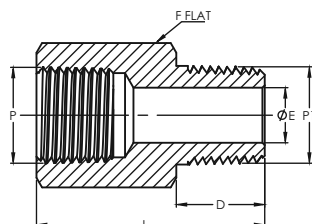

| Part Number | Pipe & ISO Thread Size (in) | | Dimensions (mm) | | | |
|----------------|-----------------------------|--------|-----------------|------|------|--------|
| | P NPT | P1 ISO | L | D | Ø E | F Flat |
| BSS-A-2N-2GT | 1/8 | 1/8 | 27.7 | 9.6 | 4.8 | 14.29 |
| BSS-A-4N-4GT | 1/4 | 1/4 | 36.1 | 14.2 | 7.1 | 19.05 |
| BSS-A-6N-6GT | 3/8 | 3/8 | 38.1 | 14.2 | 9.6 | 22.22 |
| BSS-A-8N-8GT | 1/2 | 1/2 | 49.3 | 19.1 | 11.9 | 27.00 |
| BSS-A-12N-12GT | 3/4 | 3/4 | 51.3 | 19.1 | 15.7 | 34.92 |
| BSS-A-16N-16GT | 1 | 1 | 58.4 | 23.9 | 22.4 | 41.27 |

FEMALE NPT TO MALE ISO PARALLEL THREAD

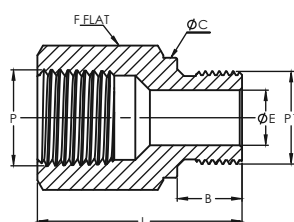

| Part Number | Pipe & ISO Thread Size (in) | | Dimensions (mm) | | | | |
|---------------|-----------------------------|--------|-----------------|------|------|------|--------|
| | P NPT | P1 ISO | L | B | Ø C | Ø E | F Flat |
| BSS-A-2N-2G | 1/8 | 1/8 | 25.1 | 8.1 | 13.7 | 4.1 | 14.29 |
| BSS-A-4N-4G | 1/4 | 1/4 | 33.5 | 11.9 | 17.8 | 5.8 | 19.05 |
| BSS-A-6N-6G | 3/8 | 3/8 | 35.8 | 11.9 | 21.8 | 7.9 | 22.22 |
| BSS-A-8N-8G | 1/2 | 1/2 | 44.2 | 14.0 | 25.9 | 11.9 | 27.00 |
| BSS-A-12N-12G | 3/4 | 3/4 | 48.0 | 16.0 | 31.8 | 15.7 | 34.92 |
| BSS-A-16N-16G | 1 | 1 | 53.3 | 18.0 | 38.9 | 19.8 | 41.27 |

FEMALE ISO TAPERED THREAD TO MALE NPT

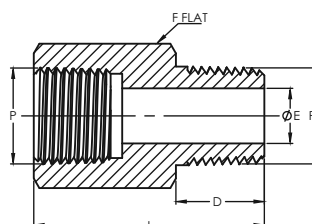

| Part Number | Pipe & ISO Thread Size (in) | | Dimensions (mm) | | | |
|--------------|-----------------------------|--------|-----------------|------|------|--------|
| | P NPT | P1 ISO | L | D | Ø E | F Flat |
| BSS-A-4GT-4N | 1/4 | 1/4 | 36.3 | 14.2 | 7.1 | 19.05 |
| BSS-A-6GT-6N | 3/8 | 3/8 | 38.4 | 14.2 | 9.6 | 22.22 |
| BSS-A-8GT-8N | 1/2 | 1/2 | 49.8 | 19.1 | 11.9 | 27.00 |

GAUGE ADAPTERS

FEMALE ISO PARALLEL THREAD TO MALE NPT

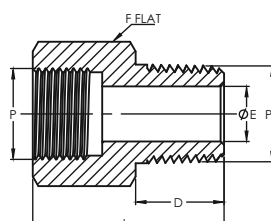

| Part Number | Pipe & ISO Thread Size (in) | | Dimensions (mm) | | | |
|--------------|-----------------------------|--------|-----------------|------|-----|--------|
| | P NPT | P1 ISO | L | D | Ø E | F Flat |
| BSS-GA-4G-4N | 1/4 | 1/4 | 30.2 | 14.2 | 5.6 | 19.05 |
| BSS-GA-6G-6N | 3/8 | 3/8 | 32.2 | 14.2 | 6.6 | 23.81 |
| BSS-GA-8G-8N | 1/2 | 1/2 | 42.7 | 19.1 | 7.1 | 27.00 |

REDUCING ADAPTERS

FEMALE TO MALE NPT

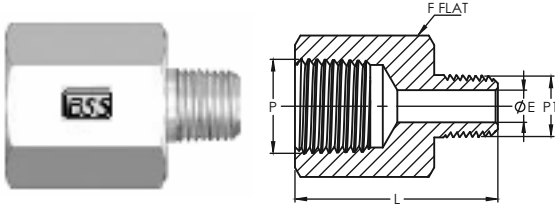

| Part Number | Pipe Size (in) | | Dimensions (mm) | | |
|----------------|----------------|--------|-----------------|------|--------|
| | P NPT | P1 NPT | L | Ø E | F Flat |
| BSS-RA-2N-1N | 1/8 | 1/16 | 27.7 | 3.0 | 14.29 |
| BSS-RA-4N-2N | 1/4 | 1/8 | 32.0 | 4.8 | 19.05 |
| BSS-RA-6N-2N | 3/8 | 1/8 | 33.8 | 4.8 | 22.22 |
| BSS-RA-6N-4N | 3/8 | 1/4 | 38.1 | 7.1 | 22.22 |
| BSS-RA-8N-2N | 1/2 | 1/8 | 40.1 | 4.8 | 27.00 |
| BSS-RA-8N-4N | 1/2 | 1/4 | 44.7 | 7.1 | 27.00 |
| BSS-RA-8N-6N | 1/2 | 3/8 | 44.4 | 9.6 | 27.00 |
| BSS-RA-12N-4N | 3/4 | 1/4 | 47.0 | 7.1 | 34.92 |
| BSS-RA-12N-6N | 3/4 | 3/8 | 46.2 | 9.6 | 34.92 |
| BSS-RA-12N-8N | 3/4 | 1/2 | 51.3 | 11.9 | 34.92 |
| BSS-RA-16N-4N | 1 | 1/4 | 49.8 | 7.1 | 41.27 |
| BSS-RA-16N-8N | 1 | 1/2 | 54.9 | 11.9 | 41.27 |
| BSS-RA-16N-12N | 1 | 3/4 | 55.1 | 15.7 | 41.27 |

FEMALE TO MALE ISO TAPERED THREAD

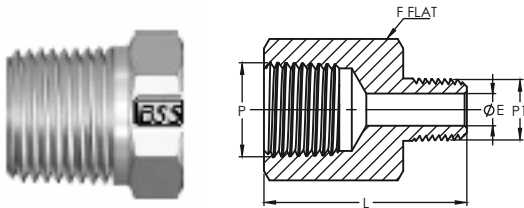

| Part Number | ISO Thread Size (in) | | Dimensions (mm) | | |
|----------------|----------------------|--------|-----------------|-----|--------|
| | P ISO | P1 ISO | L | Ø E | F Flat |
| BSS-RA-4GT-2GT | 1/4 | 1/8 | 32.0 | 4.8 | 19.05 |
| BSS-RA-6GT-4GT | 3/8 | 1/4 | 38.1 | 7.1 | 22.22 |
| BSS-RA-8GT-4GT | 1/2 | 1/4 | 44.7 | 7.1 | 27.00 |
| BSS-RA-8GT-6GT | 1/2 | 3/8 | 44.4 | 9.6 | 27.00 |

REDUCING BUSHINGS

MALE TO FEMALE ISO TAPERED THREAD

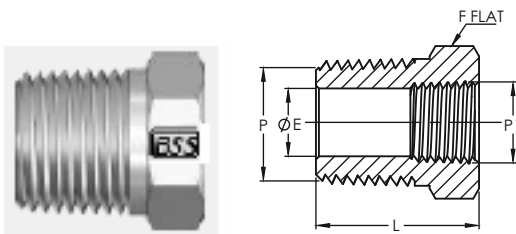

| Part Number | ISO Thread Size (in) | | Dimensions (mm) | | |
|----------------|----------------------|--------|-----------------|------|--------|
| | P ISO | P1 ISO | L | Ø E | F Flat |
| BSS-RB-4GT-2GT | 1/4 | 1/8 | 26.9 | 7.1 | 14.29 |
| BSS-RB-6GT-4GT | 3/8 | 1/4 | 30.2 | 9.6 | 19.05 |
| BSS-RB-8GT-4GT | 1/2 | 1/4 | 27.4 | 11.2 | 22.22 |
| BSS-RB-8GT-6GT | 1/2 | 3/8 | 35.8 | 11.9 | 22.22 |

MALE TO FEMALE NPT

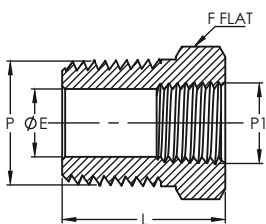

| Part Number | Pipe Size (in) | | Dimensions (mm) | | |
|----------------|----------------|--------|-----------------|------|--------|
| | P NPT | P1 NPT | L | ØE | F Flat |
| BSS-RB-2N-1N | 1/8 | 1/16 | 26.2 | 4.8 | 11.11 |
| BSS-RB-4N-2N | 1/4 | 1/8 | 26.9 | 7.1 | 14.29 |
| BSS-RB-6N-2N | 3/8 | 1/8 | 21.8 | 8.6 | 17.46 |
| BSS-RB-6N-4N | 3/8 | 1/4 | 30.2 | 9.6 | 19.05 |
| BSS-RB-8N-2N | 1/2 | 1/8 | 27.4 | 8.6 | 22.22 |
| BSS-RB-8N-4N | 1/2 | 1/4 | 27.4 | 11.4 | 22.22 |
| BSS-RB-8N-6N | 1/2 | 3/8 | 35.8 | 11.9 | 22.22 |
| BSS-RB-12N-4N | 3/4 | 1/4 | 27.4 | 11.4 | 27.00 |
| BSS-RB-12N-6N | 3/4 | 3/8 | 27.4 | 15.0 | 27.00 |
| BSS-RB-12N-8N | 3/4 | 1/2 | 41.4 | 15.7 | 27.00 |
| BSS-RB-16N-4N | 1 | 1/4 | 34.8 | 11.4 | 34.92 |
| BSS-RB-16N-6N | 1 | 3/8 | 34.8 | 15.0 | 34.92 |
| BSS-RB-16N-8N | 1 | 1/2 | 34.8 | 18.5 | 34.92 |
| BSS-RB-16N-12N | 1 | 3/4 | 47.0 | 22.4 | 34.92 |

PIPE CAPS FEMALE NPT

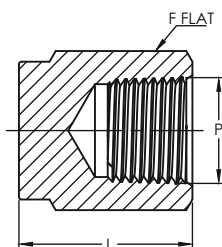

| Part Number | Pipe Size (in) P NPT | Dimensions (mm) | |
|-------------|-------------------------|-----------------|--------|
| | | L | F Flat |
| BSS-PC-2N | 1/8 | 19.1 | 14.29 |
| BSS-PC-4N | 1/4 | 23.1 | 19.05 |
| BSS-PC-6N | 3/8 | 26.2 | 22.22 |
| BSS-PC-8N | 1/2 | 34.0 | 27.00 |
| BSS-PC-12N | 3/4 | 36.6 | 34.92 |
| BSS-PC-16N | 1 | 41.1 | 41.27 |

PIPE PLUGS MALE NPT

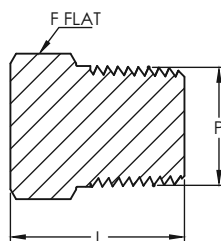

| Part Number | Pipe Size (in) P NPT | Dimensions (mm) | |
|-------------|-------------------------|-----------------|--------|
| | | L | F Flat |
| BSS-PP-1N | 1/16 | 19.1 | 7.94 |
| BSS-PP-2N | 1/8 | 19.1 | 11.11 |
| BSS-PP-4N | 1/4 | 24.4 | 14.29 |
| BSS-PP-6N | 3/8 | 25.1 | 17.46 |
| BSS-PP-8N | 1/2 | 30.7 | 22.22 |
| BSS-PP-12N | 3/4 | 30.7 | 27.00 |
| BSS-PP-16N | 1 | 38.1 | 34.92 |

HOLLOW HEX PLUGS

MALE NPT

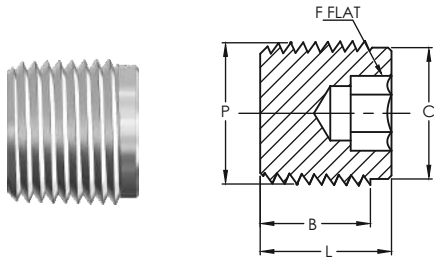

| Part Number | Pipe Size (in) | Dimensions (mm) | | | |
|-------------|----------------|-----------------|------|------|--------|
| | P NPT | L | B | C | F Flat |
| BSS-HP-2N | 1/8 | 10.4 | 7.6 | 9.4 | 4.76 |
| BSS-HP-4N | 1/4 | 15.5 | 12.4 | 12.1 | 6.35 |
| BSS-HP-6N | 3/8 | 15.0 | 11.9 | 15.7 | 7.94 |
| BSS-HP-8N | 1/2 | 19.3 | 16.2 | 19.3 | 9.52 |

ELBOWS

FEMALE NPT

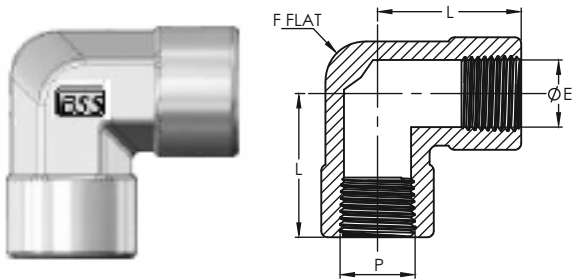

| Part Number | Pipe Size (in) | Dimensions (mm) | | |
|-------------|----------------|-----------------|------|--------|
| | P NPT | L | Ø E | F Flat |
| BSS-FE-2N | 1/8 | 26.4 | 8.6 | 12.7 |
| BSS-FE-4N | 1/4 | 29.7 | 11.4 | 17.47 |
| BSS-FE-6N | 3/8 | 36.1 | 15.0 | 20.64 |
| BSS-FE-8N | 1/2 | 39.6 | 18.5 | 25.4 |
| BSS-FE-12N | 3/4 | 48.8 | 23.9 | 31.75 |
| BSS-FE-16N | 1 | 48.5 | 29.7 | 44.45 |

FEMALE ISO TAPERED THREAD

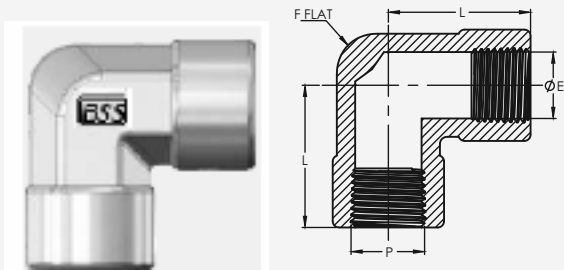

| Part Number | Thread Size (in) | Dimensions (mm) | | |
|-------------|------------------|-----------------|------|--------|
| | P ISO | L | Ø E | F Flat |
| BSS-FE-4GT | 1/4 | 29.7 | 11.2 | 17.47 |
| BSS-FE-6GT | 3/8 | 36.1 | 14.7 | 20.64 |
| BSS-FE-8GT | 1/2 | 39.6 | 18.3 | 25.4 |

MALE NPT

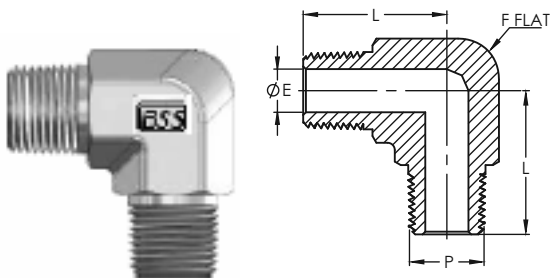

| Part Number | Pipe Size (in) | Dimensions (mm) | | |
|-------------|----------------|-----------------|------|--------|
| | P NPT | L | Ø E | F Flat |
| BSS-ME-2N | 1/8 | 22.4 | 4.8 | 11.11 |
| BSS-ME-4N | 1/4 | 26.7 | 7.1 | 12.7 |
| BSS-ME-6N | 3/8 | 29.7 | 9.6 | 17.46 |
| BSS-ME-8N | 1/2 | 36.8 | 11.9 | 20.64 |

FEMALE TO MALE NPT

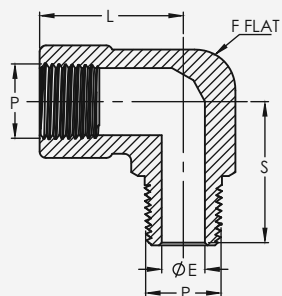

| Part Number | Pipe Size (in) | | Dimensions (mm) | | |
|-------------|----------------|------|-----------------|------|--------|
| | P NPT | L | Ø E | S | F Flat |
| BSS-SE-1N | 1/16 | 21.8 | 3.0 | 22.4 | 11.11 |
| BSS-SE-2N | 1/8 | 26.4 | 4.8 | 22.1 | 12.7 |
| BSS-SE-4N | 1/4 | 29.7 | 7.1 | 29.7 | 17.46 |
| BSS-SE-6N | 3/8 | 36.1 | 9.6 | 32.0 | 20.64 |
| BSS-SE-8N | 1/2 | 39.6 | 11.9 | 39.6 | 25.4 |
| BSS-SE-12N | 3/4 | 48.8 | 15.7 | 42.4 | 31.75 |
| BSS-SE-16N | 1 | 48.5 | 22.4 | 49.3 | 44.45 |

FEMALE TO REDUCED MALE NPT (STREET ELBOW)

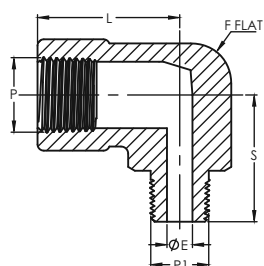

| Part Number | Pipe Size (in) | | Dimensions (mm) | | | |
|---------------|----------------|--------|-----------------|-----|------|--------|
| | P NPT | P1 NPT | L | Ø E | S | F Flat |
| BSS-RSE-1N | 1/8 | 1/16 | 26.4 | 3.0 | 22.1 | 12.7 |
| BSS-RSE-4N-2N | 1/4 | 1/8 | 29.7 | 4.8 | 25.4 | 17.46 |
| BSS-RSE-6N-4N | 3/8 | 1/4 | 36.1 | 7.1 | 32.0 | 20.64 |
| BSS-RSE-8N-4N | 1/2 | 1/4 | 39.6 | 7.1 | 35.1 | 25.4 |
| BSS-RSE-8N-6N | 1/2 | 3/8 | 39.6 | 9.6 | 35.1 | 25.4 |

TEES FEMALE NPT

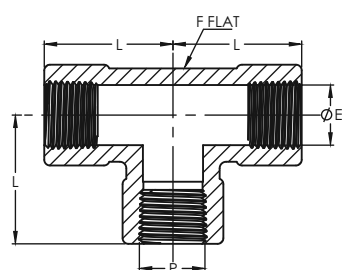

| Part Number | Pipe Size (in) | | Dimensions (mm) | |
|-------------|----------------|------|-----------------|--------|
| | P NPT | L | Ø E | F Flat |
| BSS-FT-2N | 1/8 | 26.4 | 8.6 | 12.7 |
| BSS-FT-4N | 1/4 | 29.7 | 11.4 | 17.46 |
| BSS-FT-6N | 3/8 | 36.1 | 15.0 | 20.64 |
| BSS-FT-8N | 1/2 | 39.6 | 18.5 | 25.4 |
| BSS-FT-12N | 3/4 | 48.8 | 23.9 | 31.75 |
| BSS-FT-16N | 1 | 48.5 | 29.7 | 42.45 |

FEMALE ISO TAPERED THREAD

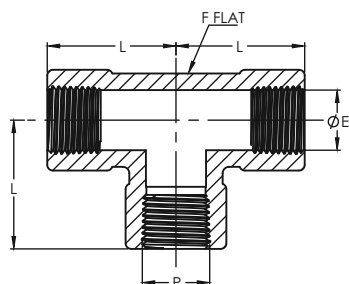

| Part Number | Thread Size (in) | | Dimensions (mm) | |
|-------------|------------------|------|-----------------|--------|
| | P ISO | L | Ø E | F Flat |
| BSS-FT-4GT | 1/4 | 29.7 | 11.2 | 17.47 |
| BSS-FT-6GT | 3/8 | 36.1 | 14.7 | 20.64 |
| BSS-FT-8GT | 1/2 | 39.6 | 18.3 | 25.4 |



MALE NPT

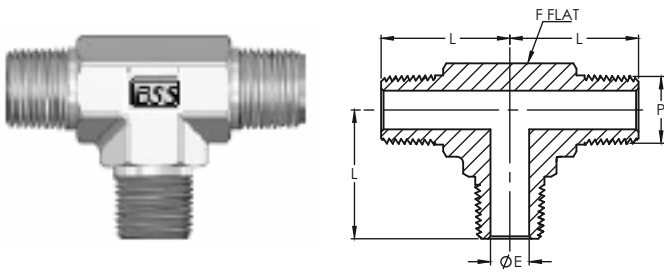

| Part Number | Pipe Size (in) | | Dimensions (mm) | | |
|-------------|----------------|-----|-----------------|------|--------|
| | P | NPT | L | ØE | F Flat |
| BSS-MT-2N | 1/8 | | 22.4 | 4.8 | 11.11 |
| BSS-MT-4N | 1/4 | | 26.7 | 7.1 | 12.7 |
| BSS-MT-6N | 3/8 | | 29.7 | 9.6 | 17.46 |
| BSS-MT-8N | 1/2 | | 36.8 | 11.9 | 20.64 |

FEMALE TO FEMALE TO MALE NPT (BRANCH TEE)

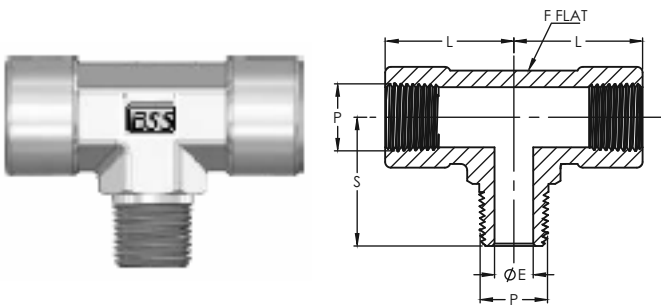

| Part Number | Pipe Size (in) | | Dimensions (mm) | | | |
|-------------|----------------|-----|-----------------|------|------|--------|
| | P | NPT | L | ØE | S | F Flat |
| BSS-BT-2N | 1/8 | | 26.4 | 4.8 | 22.1 | 12.7 |
| BSS-BT-4N | 1/4 | | 29.7 | 7.1 | 29.7 | 17.47 |
| BSS-BT-6N | 3/8 | | 36.1 | 9.6 | 32.0 | 20.64 |
| BSS-BT-8N | 1/2 | | 39.6 | 11.9 | 39.6 | 25.4 |

FEMALE TO MALE TO FEMALE NPT (STREET TEE)

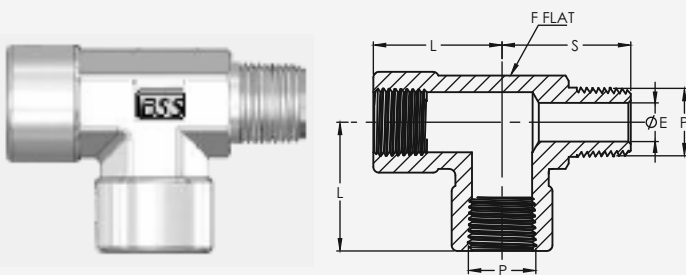

| Part Number | Pipe Size (in) | | Dimensions (mm) | | | |
|-------------|----------------|-----|-----------------|------|------|--------|
| | P | NPT | L | ØE | S | F Flat |
| BSS-ST-2N | 1/8 | | 26.4 | 4.8 | 22.1 | 12.7 |
| BSS-ST-4N | 1/4 | | 29.7 | 7.1 | 29.7 | 17.46 |
| BSS-ST-6N | 3/8 | | 36.1 | 9.6 | 32.0 | 20.64 |
| BSS-ST-8N | 1/2 | | 39.6 | 11.9 | 39.6 | 25.4 |
| BSS-ST-12N | 3/4 | | 48.8 | 15.7 | 42.4 | 31.75 |

CROSSES FEMALE NPT

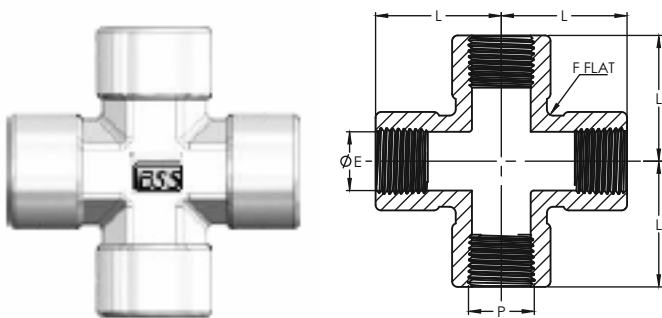

| Part Number | Pipe Size (in) | | Dimensions (mm) | | |
|-------------|----------------|-----|-----------------|------|--------|
| | P | NPT | ØE | L | F Flat |
| BSS-CS-2N | 1/8 | | 8.6 | 26.4 | 12.7 |
| BSS-CS-4N | 1/4 | | 11.4 | 29.7 | 17.46 |
| BSS-CS-6N | 3/8 | | 15.0 | 36.1 | 20.64 |
| BSS-CS-8N | 1/2 | | 18.5 | 39.6 | 25.4 |
| BSS-CS-12N | 3/4 | | 23.9 | 48.8 | 31.75 |
| BSS-CS-16N | 1 | | 29.7 | 48.5 | 44.45 |

10K THREADED FITTINGS

HEX NIPPLE - MALE NPT

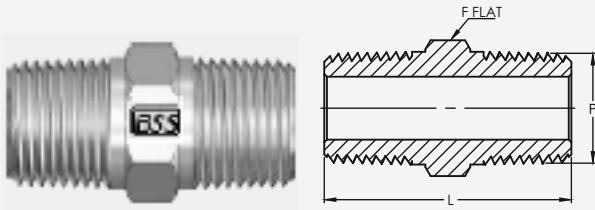

| Part Number | Pipe Size (in) P NPT | Dimensions (mm) | |
|----------------|-------------------------|-----------------|--------|
| | | L | F Flat |
| BSS-HN-2N-10K | 1/8 | 25.6 | 11.11 |
| BSS-HN-4N-10K | 1/4 | 35.5 | 14.29 |
| BSS-HN-6N-10K | 3/8 | 36.3 | 17.46 |
| BSS-HN-8N-10K | 1/2 | 46.7 | 22.22 |
| BSS-HN-12N-10K | 3/4 | 46.7 | 27 |
| BSS-HN-16N-10K | 1 | 58.9 | 34.93 |

HEX COUPLING - FEMALE NPT

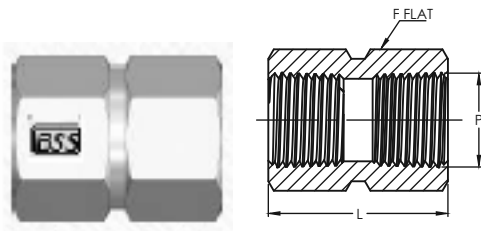

| Part Number | Pipe Size (in) P NPT | Dimensions (mm) | |
|----------------|-------------------------|-----------------|--------|
| | | L | F Flat |
| BSS-HC-2N-10K | 1/8 | 20.5 | 20.65 |
| BSS-HC-4N-10K | 1/4 | 30.2 | 25.4 |
| BSS-HC-6N-10K | 3/8 | 33.3 | 31.75 |
| BSS-HC-8N-10K | 1/2 | 39.6 | 38.1 |
| BSS-HC-12N-10K | 3/4 | 41.1 | 44.45 |
| BSS-HC-16N-10K | 1 | 50.8 | 55.0 |

ADAPTER - FEMALE TO MALE NPT

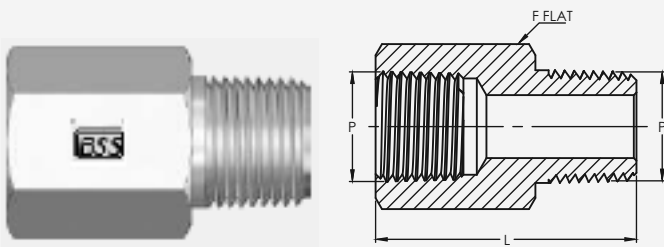

| Part Number | Pipe Size (in) P NPT | Dimensions (mm) | |
|---------------|-------------------------|-----------------|--------|
| | | L | F Flat |
| BSS-A-2N-10K | 1/8 | 27.9 | 20.65 |
| BSS-A-4N-10K | 1/4 | 36.7 | 25.4 |
| BSS-A-6N-10K | 3/8 | 38.5 | 31.75 |
| BSS-A-8N-10K | 1/2 | 51.3 | 38.1 |
| BSS-A-12N-10K | 3/4 | 52.1 | 44.4 |
| BSS-A-16N-10K | 1 | 58.7 | 55 |



REDUCING ADAPTER - FEMALE TO MALE NPT

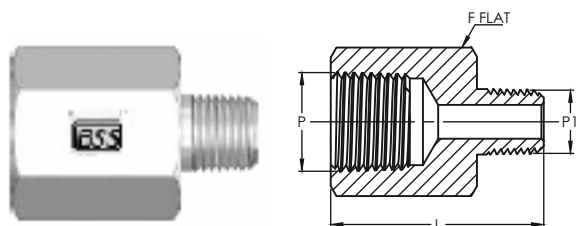

| Part Number | Pipe Size (in) | | Dimensions (mm) | |
|--------------------|----------------|--------|-----------------|--------|
| | P NPT | P1 NPT | L | F Flat |
| BSS-RA-4N-2N-10K | 1/4 | 1/8 | 32.2 | 25.4 |
| BSS-RA-6N-4N-10K | 3/8 | 1/4 | 38.5 | 31.75 |
| BSS-RA-8N-4N-10K | 1/2 | 1/4 | 46.4 | 38.1 |
| BSS-RA-12N-4N-10K | 3/4 | 1/4 | 47.2 | 44.45 |
| BSS-RA-8N-6N-10K | 1/2 | 3/8 | 46 | 38.1 |
| BSS-RA-12N-6N-10K | 3/4 | 3/8 | 47.2 | 44.45 |
| BSS-RA-16N-6N-10K | 1 | 3/8 | 49.0 | 55.0 |
| BSS-RA-12N-4N-10K | 3/4 | 1/2 | 52.1 | 44.45 |
| BSS-RA-16N-8N-10K | 1 | 1/2 | 53.9 | 55.0 |
| BSS-RA-16N-12N-10K | 1 | 3/4 | 53.9 | 55.0 |

REDUCING BUSHING - MALE TO FEMALE NPT

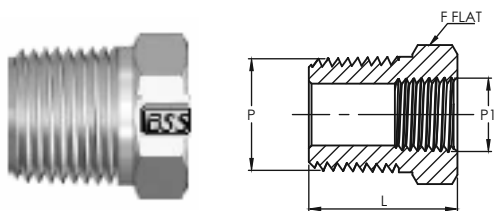

| Part Number | Pipe Size (in) | | Dimensions (mm) | |
|--------------------|----------------|--------|-----------------|--------|
| | P NPT | P1 NPT | L | F Flat |
| BSS-RA-4N-2N-10K | 1/4 | 1/8 | 32.4 | 20.64 |
| BSS-RB-6N-2N-10K | 3/8 | 1/8 | 32.4 | 20.64 |
| BSS-RB-6N-4N-10K | 3/8 | 1/4 | 36.3 | 25.4 |
| BSS-RB-8N-2N-10K | 1/2 | 1/8 | 37.3 | 22.22 |
| BSS-RB-8N-4N-10K | 1/2 | 1/4 | 41.2 | 25.4 |
| BSS-RB-8N-6N-10K | 1/2 | 3/8 | 43.4 | 31.75 |
| BSS-RB-12N-4N-10K | 3/4 | 1/4 | 41.6 | 27.0 |
| BSS-RB-12N-6N-10K | 3/4 | 3/8 | 43.4 | 31.75 |
| BSS-RB-12N-8N-10K | 3/4 | 1/2 | 51.3 | 38.1 |
| BSS-RB-16N-4N-10K | 1 | 1/4 | 46.4 | 34.92 |
| BSS-RB-16N-8N-10K | 1 | 1/2 | 55.7 | 38.1 |
| BSS-RB-16N-12N-10K | 1 | 3/4 | 56.9 | 44.45 |

PIPE CAP - FEMALE NPT

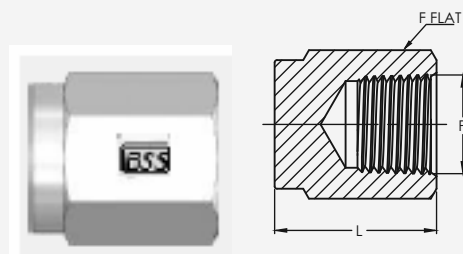

| Part Number | Pipe Size (in) P NPT | Dimensions (mm) | |
|---------------|-------------------------|-----------------|--------|
| | | L | F Flat |
| BSS-PC-4N-10K | 1/4 | 28.2 | 25.4 |
| BSS-PC-8N-10K | 1/2 | 40.1 | 38.1 |

ELBOW - FEMALE NPT

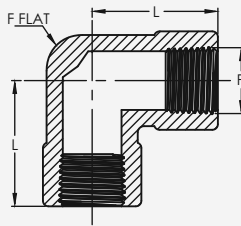

| Part Number | Pipe Size (in) P NPT | Dimensions (mm) | |
|----------------|-------------------------|-----------------|--------|
| | | L | F Flat |
| BSS-FE-2N-10K | 1/8 | 26.0 | 20.65 |
| BSS-FE-4N-10K | 1/4 | 37.0 | 25.4 |
| BSS-FE-6N-10K | 3/8 | 46.5 | 31.75 |
| BSS-FE-8N-10K | 1/2 | 50.0 | 44.45 |
| BSS-FE-12N-10K | 3/4 | 57.0 | 50.0 |
| BSS-FE-16N-10K | 1 | 57.0 | 55.0 |

TEE - FEMALE NPT

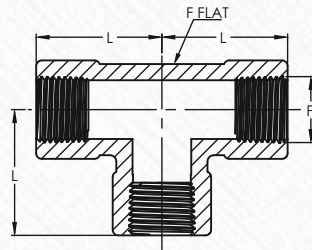

| Part Number | Pipe Size (in) P NPT | Dimensions (mm) | |
|----------------|-------------------------|-----------------|--------|
| | | L | F Flat |
| BSS-FE-2N-10K | 1/8 | 26.0 | 20.65 |
| BSS-FE-4N-10K | 1/4 | 37.0 | 25.4 |
| BSS-FE-6N-10K | 3/8 | 46.5 | 31.75 |
| BSS-FE-8N-10K | 1/2 | 50.0 | 44.45 |
| BSS-FE-12N-10K | 3/4 | 57.0 | 50.0 |
| BSS-FE-16N-10K | 1 | 57.0 | 55.0 |

CROSS - FEMALE NPT

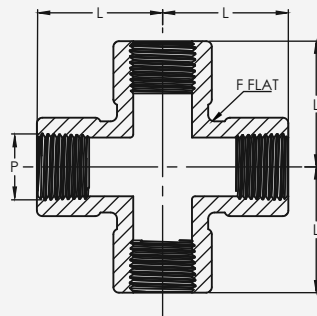

| Part Number | Pipe Size (in) P NPT | Dimensions (mm) | |
|----------------|-------------------------|-----------------|--------|
| | | L | F Flat |
| BSS-CS-2N-10K | 1/8 | 26 | 20.64 |
| BSS-CS-4N-10K | 1/4 | 37 | 25.4 |
| BSS-CS-6N-10K | 3/8 | 46.5 | 31.75 |
| BSS-CS-8N-10K | 1/2 | 50 | 44.45 |
| BSS-CS-12N-10K | 3/4 | 57 | 50.0 |
| BSS-CS-16N-10K | 1 | 57 | 55.0 |

THREADED FITTINGS OVER 1 INCH



HEX NIPPLE - MALE NPT

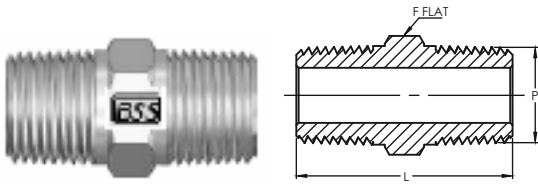

| Part Number | Pipe Size (in) P NPT | Dimensions (mm) | | Working Pressure | |
|-------------|-------------------------|-----------------|--------|------------------|-----|
| | | L | F Flat | psig | bar |
| BSS-FT-20N | 1-1/4 | 61.2 | 44.45 | 6000 | 413 |
| BSS-FT-24N | 1-1/2 | 68 | 50.8 | 6000 | 413 |
| BSS-FT-32N | 2 | 69.8 | 70 | 6000 | 413 |

HEX COUPLING - FEMALE NPT

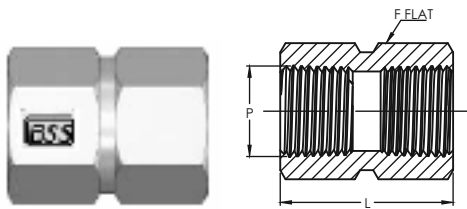

| Part Number | Pipe Size (in) P NPT | Dimensions (mm) | | Working Pressure | |
|-------------|-------------------------|-----------------|--------|------------------|-----|
| | | L | F Flat | psig | bar |
| BSS-HC-20N | 1-1/4 | 66.5 | 55.0 | 6000 | 413 |
| BSS-HC-24N | 1-1/2 | 66.5 | 70.0 | 6000 | 413 |
| BSS-HC-32N | 2 | 66.5 | 76.2 | 6000 | 413 |

ELBOW - FEMALE NPT

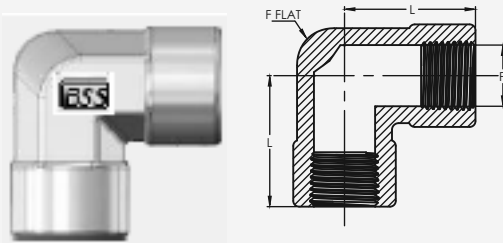

| Part Number | Pipe Size (in) P NPT | Dimensions (mm) | | Working Pressure | |
|-------------|-------------------------|-----------------|--------|------------------|-----|
| | | L | F Flat | psig | bar |
| BSS-FE-20N | 1-1/4 | 70 | 70 | 6000 | 413 |
| BSS-FE-24N | 1-1/2 | 70 | 70 | 6000 | 413 |
| BSS-FE-32N | 2 | 70 | 76.2 | 6000 | 413 |

TEE - FEMALE NPT

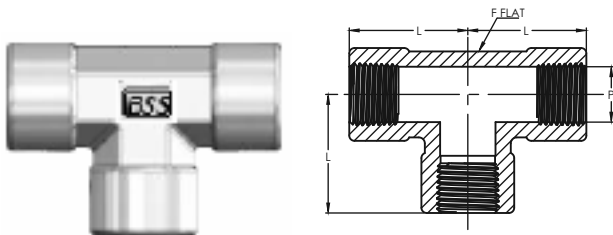

| Part Number | Pipe Size (in) P NPT | Dimensions (mm) | | Working Pressure | |
|-------------|-------------------------|-----------------|--------|------------------|-----|
| | | L | F Flat | psig | bar |
| BSS-FT-20N | 1-1/4 | 70 | 70 | 6000 | 413 |
| BSS-FT-24N | 1-1/2 | 70 | 70 | 6000 | 413 |
| BSS-FT-32N | 2 | 70 | 76.2 | 6000 | 413 |

CROSS - FEMALE NPT

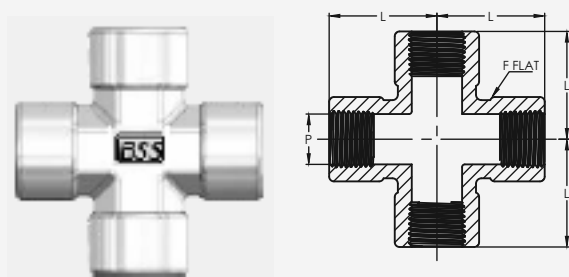

| Part Number | Pipe Size (in) P NPT | Dimensions (mm) | | Working Pressure | |
|-------------|-------------------------|-----------------|--------|------------------|-----|
| | | L | F Flat | psig | bar |
| BSS-CS-20N | 1-1/4 | 70 | 70 | 6000 | 413 |
| BSS-CS-24N | 1-1/2 | 70 | 70 | 6000 | 413 |
| BSS-CS-32N | 2 | 70 | 76.2 | 6000 | 413 |

WELD FITTINGS

MALE CONNECTOR

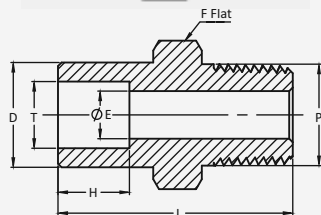

| Part Number | T Tube OD | P NPT | ØE mm | D mm | H mm | F Flat mm | L mm | Working Pressure | |
|----------------|--------------|----------|----------|---------|---------|--------------|---------|------------------|-----|
| | | | | | | | | Psig | Bar |
| BSS-MCSW-4T-6N | 1/4 | 1/4 | 4.6 | 12.2 | 7.1 | 14.29 | 29.2 | 7,500 | 516 |
| BSS-MCSW-6T-4N | 3/8 | 1/4 | 7.1 | 15.3 | 7.9 | 15.89 | 31.8 | 7,500 | 516 |
| BSS-MCSW-6T-6N | 3/8 | 3/8 | 7.1 | 15.3 | 7.9 | 17.46 | 31.8 | 7,300 | 502 |
| BSS-MCSW-6T-8N | 3/8 | 1/2 | 7.1 | 15.3 | 7.9 | 22.22 | 37.8 | 7,200 | 496 |
| BSS-MCSW-8T-4N | 1/2 | 1/4 | 7.1 | 18.5 | 9.7 | 19.05 | 33.3 | 6,200 | 427 |
| BSS-MCSW-8T-6N | 1/2 | 3/8 | 9.4 | 18.5 | 9.7 | 19.05 | 33.3 | 6,200 | 427 |
| BSS-MCSW-8T-8N | 1/2 | 1/2 | 10.2 | 18.5 | 9.7 | 22.22 | 38.9 | 6,200 | 427 |

FEMALE CONNECTOR

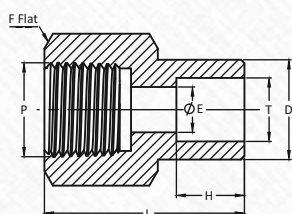

| Part Number | T Tube OD | P NPT | ØE mm | D mm | H mm | F Flat mm | L mm | Working Pressure | |
|------------------|--------------|----------|----------|---------|---------|--------------|---------|------------------|-----|
| | | | | | | | | Psig | Bar |
| BSS-FCSW-2T-4N | 1/8 | 1/8 | 2.3 | 7.4 | 2.5 | 14.29 | 21.1 | 6,100 | 420 |
| BSS-FCSW-4T-2N | 1/4 | 1/8 | 4.6 | 12.2 | 7.1 | 14.29 | 26.7 | 6,100 | 420 |
| BSS-FCSW-4T-4N | 1/4 | 1/4 | 4.6 | 12.2 | 7.1 | 19.05 | 30.0 | 6,200 | 427 |
| BSS-FCSW-6T-4N | 3/8 | 1/4 | 7.1 | 15.3 | 7.9 | 19.05 | 31.5 | 6,200 | 427 |
| BSS-FCSW-8T-6N | 1/2 | 3/8 | 10.2 | 18.5 | 9.7 | 22.22 | 34.5 | 5,000 | 344 |
| BSS-FCSW-8T-8N | 1/2 | 1/2 | 10.2 | 18.5 | 9.7 | 27.00 | 40.4 | 4,600 | 316 |
| BSS-FCSW-10T-8N | 5/8 | 1/2 | 12.7 | 23.4 | 10.4 | 27.00 | 41.9 | 4,600 | 316 |
| BSS-FCSW-12T-12N | 3/4 | 3/4 | 15.7 | 26.7 | 11.2 | 33.00 | 43.9 | 4,300 | 296 |

UNION - TUBE TO TUBE

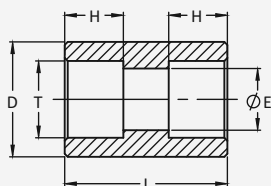

| Part Number | T Tube OD | ØE mm | D mm | H mm | L mm | Working Pressure | |
|-------------|--------------|----------|---------|---------|---------|------------------|-----|
| | | | | | | Psig | Bar |
| BSS-USW-4T | 1/4 | 4.6 | 13.0 | 7.1 | 19.0 | 10,000 | 689 |
| BSS-USW-6T | 3/8 | 7.1 | 15.8 | 7.9 | 22.4 | 7,600 | 523 |
| BSS-USW-8T | 1/2 | 10.2 | 19.0 | 9.7 | 26.9 | 6,200 | 427 |
| BSS-USW-10T | 5/8 | 12.7 | 24.0 | 10.4 | 30.2 | 6,400 | 440 |
| BSS-USW-12T | 3/4 | 15.7 | 26.9 | 11.2 | 33.3 | 5,500 | 378 |
| BSS-USW-16T | 1 | 22.1 | 35 | 15.7 | 36.6 | 5,200 | 358 |

PIPE TO TUBE SOCKET WELD

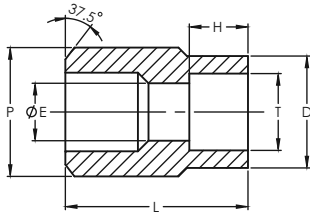

| Part Number | T Tube OD | P NPT | ØE mm | D mm | H mm | L mm | Working Pressure | |
|-----------------|--------------|----------|----------|---------|---------|---------|------------------|-----|
| | | | | | | | Psig | Bar |
| BSS-TTSW-4T-4N | 1/4 | 1/4 | 4.6 | 13.7 | 7.1 | 22.4 | 9,600 | 661 |
| BSS-TTSW-6T-6N | 3/8 | 3/8 | 7.1 | 15.3 | 7.9 | 26.2 | 7,600 | 523 |
| BSS-TTSW-6T-8N | 3/8 | 1/2 | 10.2 | 18.5 | 9.7 | 27.9 | 6,200 | 427 |
| BSS-TTSW-8T-4N | 1/2 | 1/4 | 4.6 | 12.2 | 7.1 | 28.4 | 7,300 | 502 |
| BSS-TTSW-8T-6N | 1/2 | 3/8 | 7.1 | 15.3 | 7.9 | 28.4 | 7,300 | 502 |
| BSS-TTSW-8T-8N | 1/2 | 1/2 | 10.2 | 18.5 | 9.7 | 30.2 | 6,200 | 427 |
| BSS-TTSW-12T-6N | 3/4 | 3/8 | 7.1 | 15.3 | 7.9 | 38.1 | 6,200 | 427 |
| BSS-TTSW-12T-8N | 3/4 | 1/2 | 10.2 | 18.5 | 9.7 | 38.1 | 6,200 | 427 |

TUBE TO TUBE SOCKET WELD

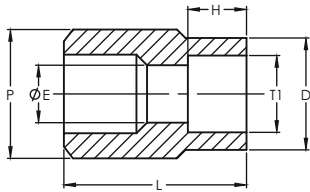

| Part Number | T Tube OD | P NPT | ØE mm | D mm | H mm | L mm | Working Pressure | |
|-----------------|--------------|----------|----------|---------|---------|---------|------------------|-----|
| | | | | | | | Psig | Bar |
| BSS-TTSW-4T-2T | 1/4 | 1/8 | 2.3 | 7.4 | 2.5 | 14.2 | 11,800 | 813 |
| BSS-TTSW-6T-4T | 3/8 | 1/4 | 4.6 | 12.2 | 7.1 | 19.1 | 7,700 | 530 |
| BSS-TTSW-8T-4T | 1/2 | 1/4 | 4.6 | 12.7 | 7.1 | 22.4 | 7,000 | 482 |
| BSS-TTSW-8T-6T | 1/2 | 3/8 | 8.1 | 15.7 | 7.9 | 22.4 | 7,000 | 482 |
| BSS-TTSW-12T-8T | 3/4 | 1/2 | 10.2 | 18.5 | 9.7 | 28.4 | 5,900 | 406 |
| BSS-TTSW-16T-8T | 1 | 1/2 | 10.2 | 18.5 | 9.7 | 35.1 | 5,600 | 386 |

MALE ELBOW

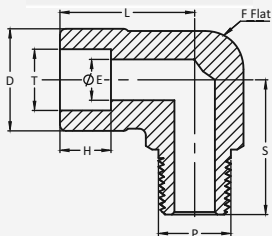

| Part Number | T Tube OD | P NPT | ØE mm | D mm | H mm | F Flat mm | L mm | S mm | Working Pressure | |
|------------------|--------------|----------|----------|---------|---------|--------------|---------|---------|------------------|-----|
| | | | | | | | | | Psig | Bar |
| BSS-MESW-4T-4N | 1/4 | 1/4 | 4.6 | 15.8 | 7.1 | 12.7 | 20.1 | 24.5 | 7,500 | 516 |
| BSS-MESW-6T-4N | 3/8 | 1/4 | 7.1 | 15.8 | 7.9 | 12.7 | 24.1 | 24.5 | 7,500 | 516 |
| BSS-MESW-6T-6N | 3/8 | 3/8 | 7.1 | 20.6 | 7.9 | 17.46 | 24.6 | 29.0 | 7,300 | 502 |
| BSS-MESW-6T-8N | 3/8 | 1/2 | 7.1 | 15.2 | 7.9 | 20.64 | 25.9 | 34.5 | 7,200 | 496 |
| BSS-MESW-8T-8N | 1/2 | 1/2 | 10.2 | 20.6 | 9.7 | 20.64 | 27.4 | 34.5 | 6,200 | 427 |
| BSS-MESW-12T-12N | 3/4 | 3/4 | 15.7 | 28.6 | 11.2 | 25.4 | 37.0 | 37.0 | 6,700 | 461 |

FEMALE ELBOW

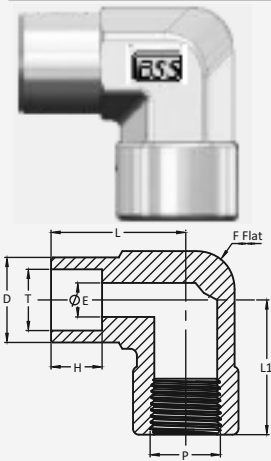

| Part Number | T Tube OD | P NPT | ØE mm | D mm | H mm | F Flat mm | L mm | L1 mm | Working Pressure | |
|----------------|--------------|----------|----------|---------|---------|--------------|---------|----------|------------------|-----|
| | | | | | | | | | Psig | Bar |
| BSS-FESW-4T-4N | 1/4 | 1/4 | 4.6 | 12.2 | 7.1 | 17.46 | 22.9 | 29.7 | 6,200 | 427 |
| BSS-FESW-6T-4N | 3/8 | 1/4 | 7.1 | 15.3 | 7.9 | 17.46 | 25.1 | 29.7 | 7,000 | 482 |
| BSS-FESW-6T-8N | 3/8 | 1/2 | 7.1 | 15.3 | 7.9 | 25.4 | 28.7 | 37.0 | 5,400 | 372 |
| BSS-FESW-8T-8N | 1/2 | 1/2 | 10.2 | 18.5 | 9.7 | 25.4 | 30.2 | 37.0 | 5,400 | 372 |

UNION ELBOW

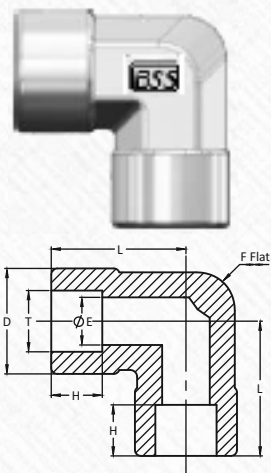

| Part Number | T Tube OD | ØE mm | D mm | H mm | F Flat mm | L mm | Working Pressure | |
|--------------|--------------|----------|---------|---------|--------------|---------|------------------|-----|
| | | | | | | | Psig | Bar |
| BSS-UESW-4T | 1/4 | 4.6 | 13.4 | 7.1 | 12.7 | 21.8 | 11,300 | 778 |
| BSS-UESW-6T | 3/8 | 7.1 | 15.8 | 7.9 | 12.7 | 24.5 | 8,400 | 578 |
| BSS-UESW-8T | 1/2 | 10.2 | 20.6 | 9.7 | 17.46 | 29.0 | 7,800 | 537 |
| BSS-UESW-10T | 5/8 | 12.7 | 23.8 | 10.4 | 20.64 | 34.5 | 6,700 | 461 |
| BSS-UESW-12T | 3/4 | 15.7 | 28.6 | 11.2 | 25.4 | 37.0 | 6,700 | 461 |
| BSS-UESW-16T | 1 | 22.1 | 35.0 | 15.7 | 31.75 | 46.5 | 5,800 | 400 |

UNION TEE

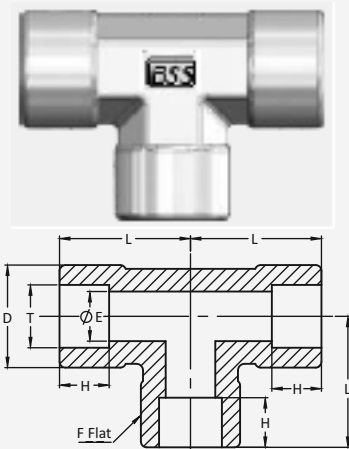

| Part Number | T Tube OD | ØE mm | D mm | H mm | F Flat mm | L mm | Working Pressure | |
|--------------|--------------|----------|---------|---------|--------------|---------|------------------|-----|
| | | | | | | | Psig | Bar |
| BSS-UTSW-2T | 1/8 | 2.3 | 13.4 | 2.5 | 12.7 | 15.0 | 11,800 | 813 |
| BSS-UTSW-4T | 1/4 | 4.6 | 13.4 | 7.1 | 12.7 | 21.8 | 11,300 | 778 |
| BSS-UTSW-6T | 3/8 | 7.1 | 15.8 | 7.9 | 12.7 | 24.0 | 8,400 | 578 |
| BSS-UTSW-8T | 1/2 | 10.2 | 20.6 | 9.7 | 17.46 | 29.0 | 7,800 | 537 |
| BSS-UTSW-10T | 5/8 | 12.7 | 23.8 | 10.4 | 20.64 | 34.5 | 6,700 | 461 |
| BSS-UTSW-12T | 3/4 | 15.7 | 28.6 | 11.2 | 25.4 | 37.0 | 6,700 | 461 |
| BSS-UTSW-16T | 1 | 22.1 | 35.0 | 15.7 | 31.75 | 46.5 | 5,800 | 400 |